

41-46 PICCADILLY

MAYFAIR W1

Up to 8,900 sq ft of prime retail space on Piccadilly – one of London's most iconic streets.





A globally recognised retail destination: Piccadilly

World famous home to some of the cornerstones of London's unique retail, hospitality and cultural heritage.

A busy thoroughfare located between Green Park and Piccadilly Circus underground stations and marking the junction between stylish Mayfair and traditional St James's. Piccadilly Circus sees around 100 Million visitors annually.



The Area

Mayfair and St James's comprises the world's finest retail destinations, restaurants, cafes, hotels and cultural destinations, many of which are one-of-a-kind experiences catering to visitors from across the globe.

Ranging from the luxury and style of Mayfair's flagship stores, boutiques and eateries to the understated traditional specialists and galleries in St James, Piccadilly sits astride both.

● Food

- 1 The Wolseley
- 2 Gymkhana
- 3 Bocconcino
- 4 Cecconi's
- 5 Hawksmoor
- 6 Mountain
- 7 Ambassadors Clubhouse
- 8 Sabor
- 9 Quaglino's
- 10 Gaia
- 11 Hakkasan
- 12 Sexy Fish
- 13 Bob Bob Ricard
- 14 Amazonico
- 15 Rowley's
- 16 Bentley's Oyster Bar & Grill
- 17 Maison François
- 18 Franco's
- 19 Sketch
- 20 Novikov

● Arts & Culture

- 21 Piccadilly Theatre
- 22 The Royal Institution
- 23 Apollo Theatre
- 24 Royal Academy of Arts
- 25 His Majesty's Theatre
- 26 Piccadilly Arcade
- 27 Sotheby's

● Retail

- 28 Tiffany & Co.
- 29 Fortnum & Mason
- 30 Burlington Arcade
- 31 Burberry
- 32 Chanel
- 33 Gymshark
- 34 Whole Foods Market
- 35 Louis Vuitton
- 36 Prada
- 37 Ralph Lauren
- 38 Orlebar Brown
- 39 Princes Arcade
- 40 Paxton & Whitfield
- 41 Berry Bros. & Rudd
- 42 Dover Street Market
- 43 Church's
- 44 Celine
- 45 Gucci
- 46 Jimmy Choo
- 47 Waterstones
- 48 Hatchards
- 49 Restoration Hardware

● Hotels

- 50 The Ritz
- 51 The Londoner
- 52 Ham Yard
- 53 The May Fair
- 54 The Cavendish

● Drinks / Cafes

- 55 The Burlington Arms
- 56 The Arts Club
- 57 Chequers Tavern
- 58 8 at The Londoner
- 59 St James Tavern
- 60 The May Fair Bar
- 61 The Rivoli Bar
- 62 The Dragon Room
- 63 Socialista
- 64 Mr Fogg's Residence
- 65 Farmer J
- 66 Ole & Steen
- 67 Joe & The Juice
- 68 Guinea Grill
- 69 The Devonshire

● Fitness

- 70 E by Equinox
- 71 PureGym
- 72 Third Space
- 73 Nordic Balance
- 74 Barry's

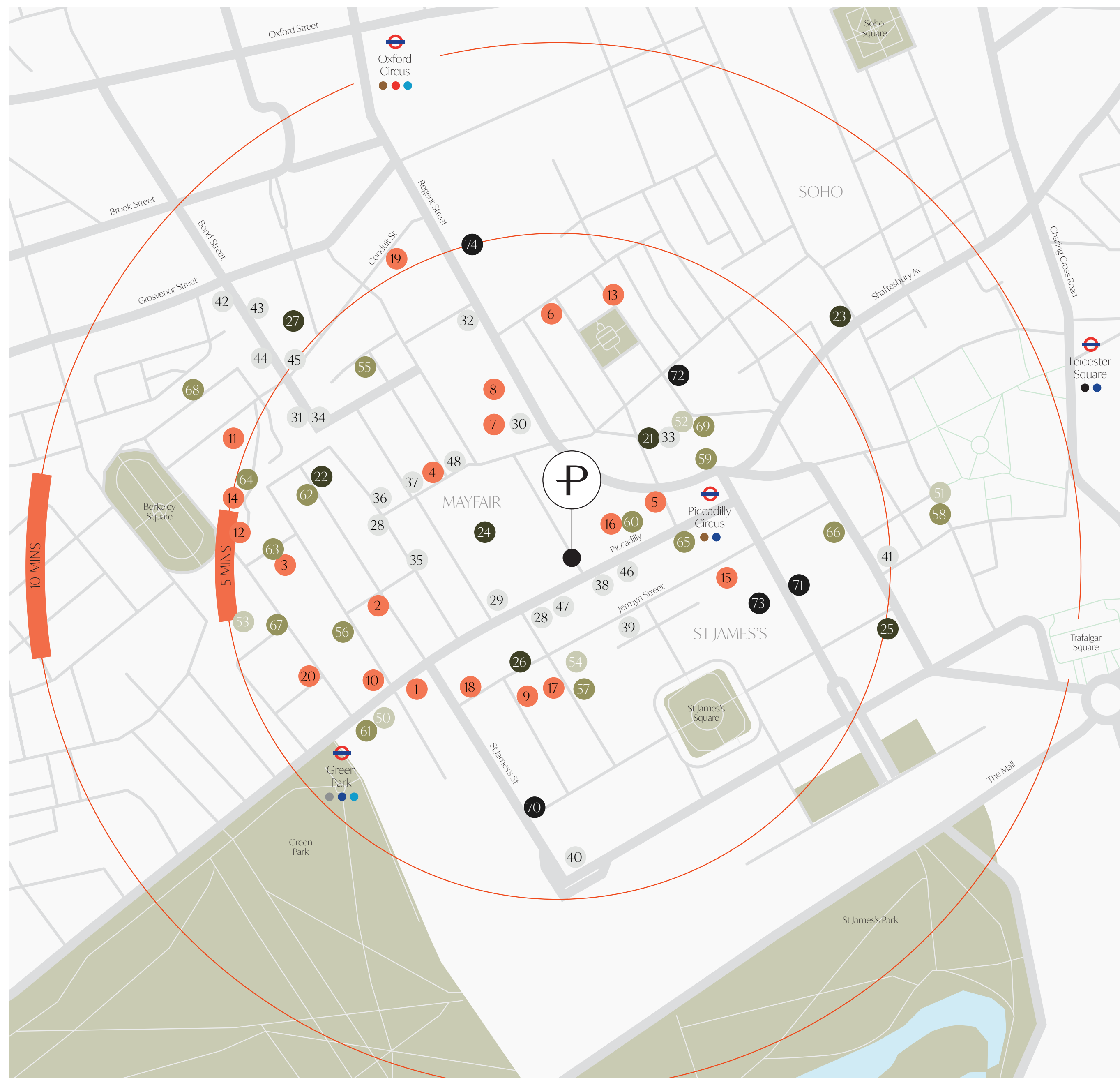

Local Occupiers

The local area comprises an exciting mix of retail destinations, ranging from the luxury of Bond Street and Burlington Arcade to the centres of traditional excellence in menswear found in Savile Row and Jermyn Street.

Piccadilly's destinalional credentials are world famous: The Ritz Hotel; Fortnum & Mason, Hatchards and Waterstones (Europe's largest bookshop) alongside more contemporary and specialist businesses: Bentley and Skinner, Ferrari, Luca Faloni, Maison Assouline and Arc'teryx.



Offering nearly 40m frontage onto Piccadilly, 41-46 Piccadilly represents a rare opportunity to secure a true flagship on one of London's busiest streets.

The flexible space is available as a whole or may be split to suit.

Piccadilly Retail Unit	SQ FT*	SQ M*
Ground Floor	3,864	359
Lower Ground Floor	5,027	467
Total	8,891	826

*All areas provided are measured as Gross Internal Area (GIA)

Ground Floor

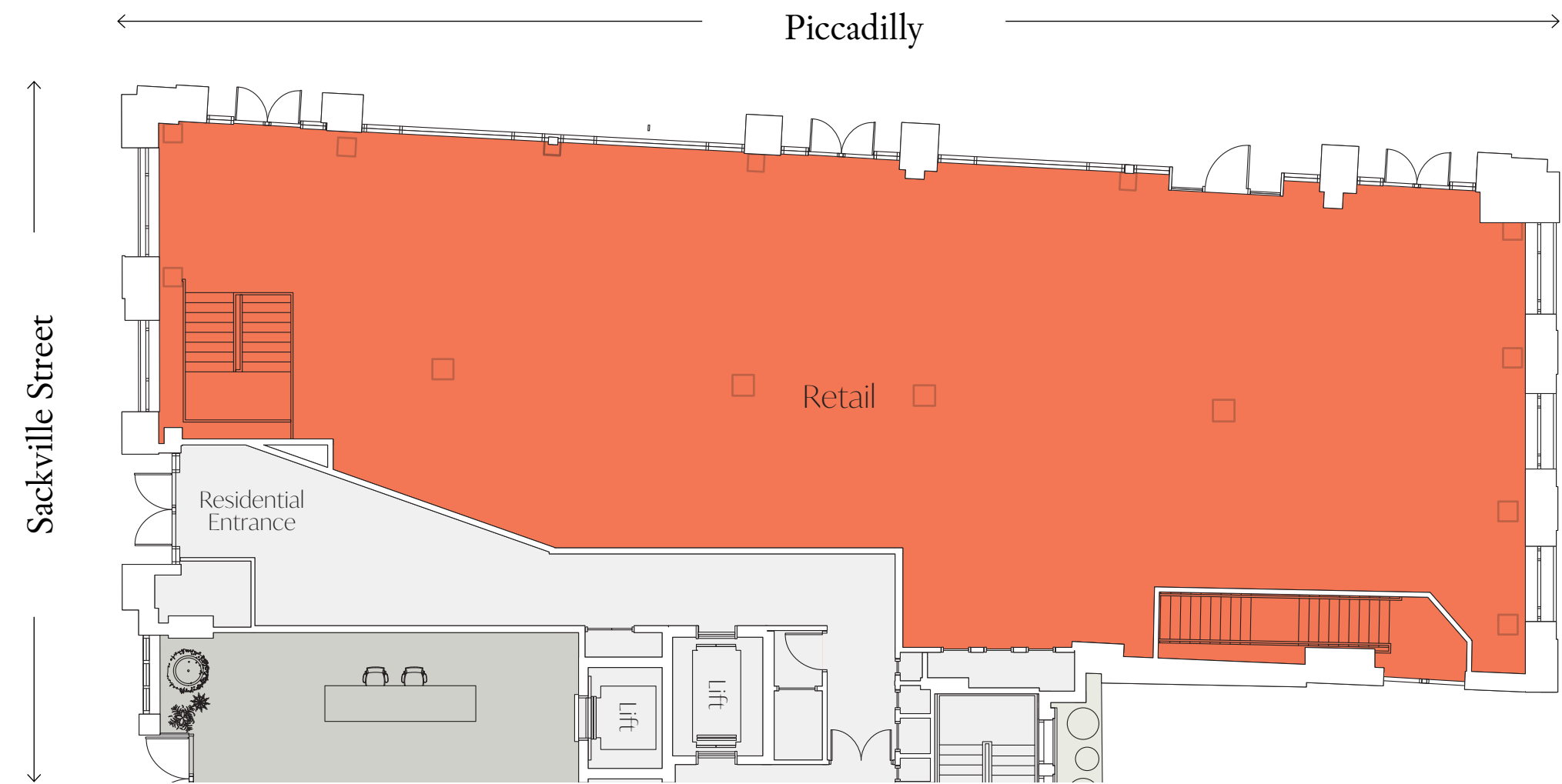

Lower Ground Floor



Details

Tenure

The shops are available to let by way of new effectively full repairing and insuring leases for a term to be agreed. The leases will be contracted outside of the security of tenure and compensations provisions of the Landlord & Tenant Act 1954 Part II (as amended).

Rent

On Application.

Handover

The shops are to be handed over in shell and core condition with shopfronts.

Business rates

To be reassessed – an estimate is available on request.

Service charge & insurance

A service charge and insurance will be applicable, further information available on request.

Timing

The shops will be available to handover end Q2 2026.



A development
by **Aviva Investors**



James Andrews
jandrews@klm-re.com
+44 (0) 7768 865 913

Tom Jamson
tjamson@klm-re.com
+44 (0) 7769 704 493

The Agents for themselves and for the vendors or lessors of this property whose agents they are, give notice that: (1) The particulars are produced in good faith, are set out as a general guide only and do not constitute part of a contract, (2) No person in the employment of the Joint Agents has any authority to make or give any representation or warranty whatsoever in relation to this property, (3) Unless otherwise stated all prices and rents are quoted exclusive of VAT, (4) CGIs for indicative purposes only. November 2025. Designed by J2.net